

GHIERE DI BLOCCAGGIO TIPO KM

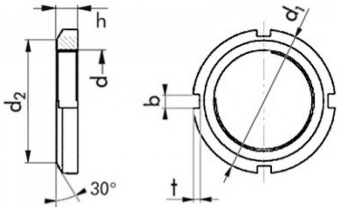

Ghiera di bloccaggio tipo KM

- A norma DIN 981
- In acciaio grezzo
- Passo metrico



Ø	Art.
m 100	F0374 100 2
m 110	F0374 110 2
m 135	F0374 135 2
m 15	F0374 15 1
m 150	F0374 150 2
m 155	F0374 155 3
m 17	F0374 17 1
m 17	F0374 40 15
m 190	F0374 190 3
m 20	F0374 20 15
m 25	F0374 25 15
m 30	F0374 30 15
m 35	F0374 35 15
m 45	F0374 45 15
m 50	F0374 50 15
m 55	F0374 55 2
m 60	F0374 60 2
m 65	F0374 65 2
m 70	F0374 70 2
m 75	F0374 75 2
m 80	F0374 80 2
m 85	F0374 85 2
m 90	F0374 90 2
m 95	F0374 95 2

